

# The Seven Springs–Mill Creek Village

## Majestic Mountaintop Luxury Home Sites Along the Blue Ridge Parkway at 3,000 Foot Elevation

Mill Creek Village consists of eleven home sites, ranging from 2.058 to 4.050 acres. These wooded sites in **The Seven Springs** are varied in character and include beautiful, soaring hardwoods and rhododendron and mountain laurel in abundance. All sites include one or more of views of the surrounding mountains and ridges, rock outcroppings, a pristine mountain stream or springhead or down-mountain piedmont views into North Carolina. Each parcel has its own character and all are wonderful! Access to home sites are from the interior cul-de-sac access road. Sites are permit-approved for septic and well and will have both underground electricity and telephone service (after required and applied for by owner). A title insurance commitment will be provided as well as surveys of the Village and the home site and a copy of the Association's Declarations and By-Laws.

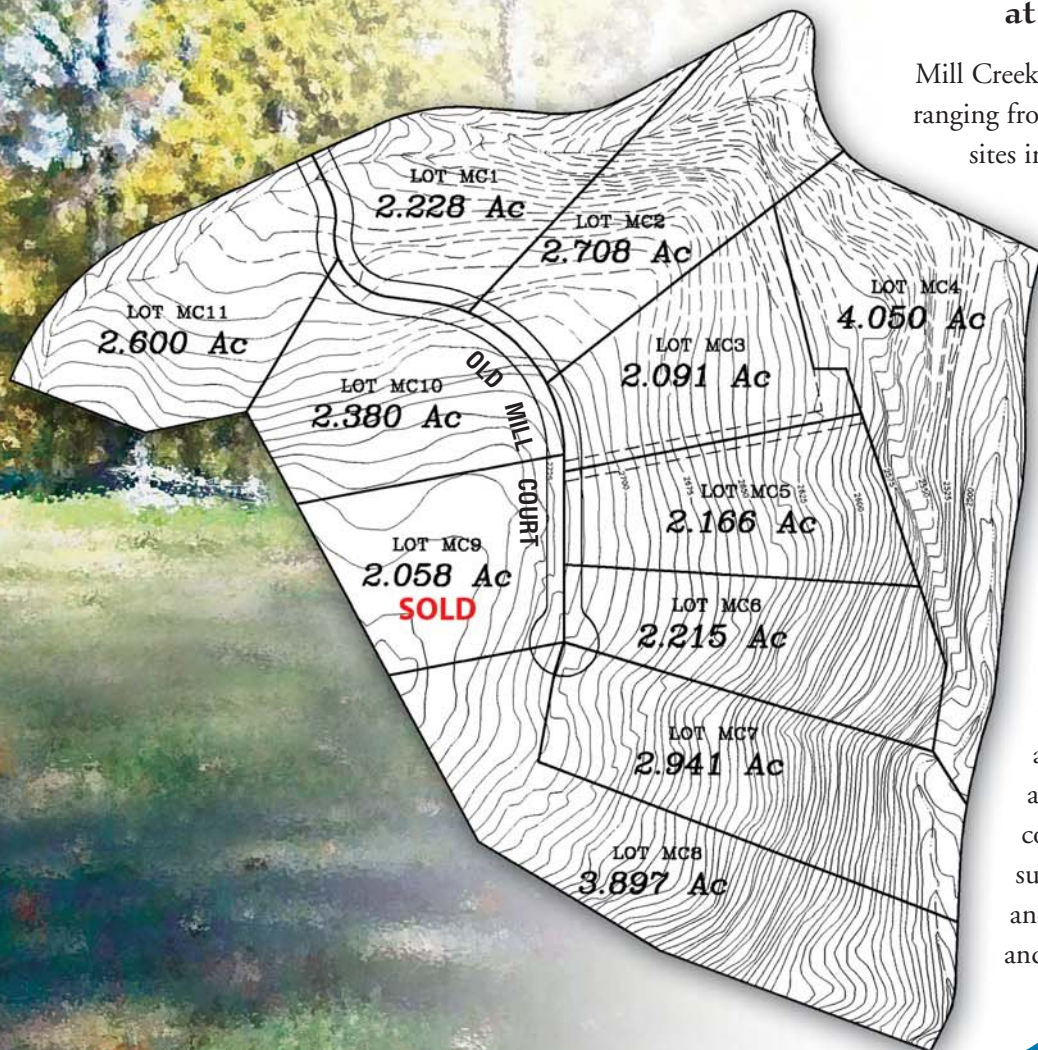

  
**VIRGINIA PARKWAY ESTATES** LIMITED PARTNERSHIP  
ALONG THE BLUE RIDGE PARKWAY

Mile Posts 192 & 193 • P.O. Box 37 • Fancy Gap, Virginia 24328  
866-MTS-OF-VA • Fax: 276-398-2082  
e-mail: [info@thesevensprings.com](mailto:info@thesevensprings.com)

# The Seven Springs–Mill Creek Village

Majestic Mountaintop Luxury Home Sites  
Along the Blue Ridge Parkway  
at 3,000 Foot Elevation

## Mill Creek Village - Lot Descriptions and Prices\*\* March 2008

Lot #		Prices	Acreage
# 1	Views of Adjacent Ridges. Stream Entire Length. Wooded. Borders Seven Springs Parkway.	29,925	2.228
# 2	Views of Adjacent Ridges. Stream Through Corner of Lot. Outcropping of Rock. Wooded.	33,900	2.708
# 3	Views of Adjacent Mountains. Wooded.	39,900	2.091
# 4	Views of Adjacent Mountains. Stream Entire Length. Wooded. Outcropping of Rock. Borders Seven Springs Parkway and Willis Gap Mountain Road. Potential For Private Entrance Road.	45,900 <b>SOLD *</b>	4.050
# 5	Views of Adjacent Mountains. Partial view of Piedmont. Wooded.	42,900	2.166
# 6	Views of Adjacent Mountains. Partial view of Piedmont. Wooded. Large Outcropping of Rock.	42,900	2.215
# 7	Views of Adjacent Mountains. Partial view of Piedmont. Stream Along Lot Line. Wooded. Large Outcropping of Rock.	47,900	2.941
#8	Views of Adjacent Mountains. Partial view of Piedmont. Wooded. Stream Along Lot Line. Large Outcropping of Rock.	57,900	3.897
# 9	Views of Adjacent Mountains and Ridges. Wooded.	<b>SOLD</b>	2.058
# 10	Views of Adjacent Ridges. Wooded.	42,900	2.380
# 11	Views of Adjacent Ridges. Stream Entire Length. Wooded. Borders Seven Springs Parkway.	47,900	2.600

\* Pending \*\* Prices and Lot Availability are Subject to Change.



**VIRGINIA PARKWAY ESTATES** LIMITED PARTNERSHIP  
ALONG THE BLUE RIDGE PARKWAY

Mile Posts 192 & 193 • P.O. Box 37 • Fancy Gap, Virginia 24328  
866-MTS-OF-VA • Fax: 276-398-2082  
e-mail: [info@thesevensprings.com](mailto:info@thesevensprings.com)